

Food & Beverage (F&B)

There is a required food & beverage minimum per reservable space, plus 11% sales tax and 25% service charge. Other fees may apply.

Semiprivate

Capacity: 125 Seated | 200 Standing

Lunch | 12-3pm | \$10,000  
Dinner | 5-10pm | \$20,000  
Brunch | 11am-3pm | \$15,000  
  
(Includes Jula's Veuve Lounge, the Dining Room, and the Waterfront Balcony)

Full Buyout

Capacity: 125 Seated | 300 Standing

Lunch | 12-3pm | \$12,000  
Dinner | 5-10pm | \$25,000  
Brunch | 11am-3pm | \$20,000

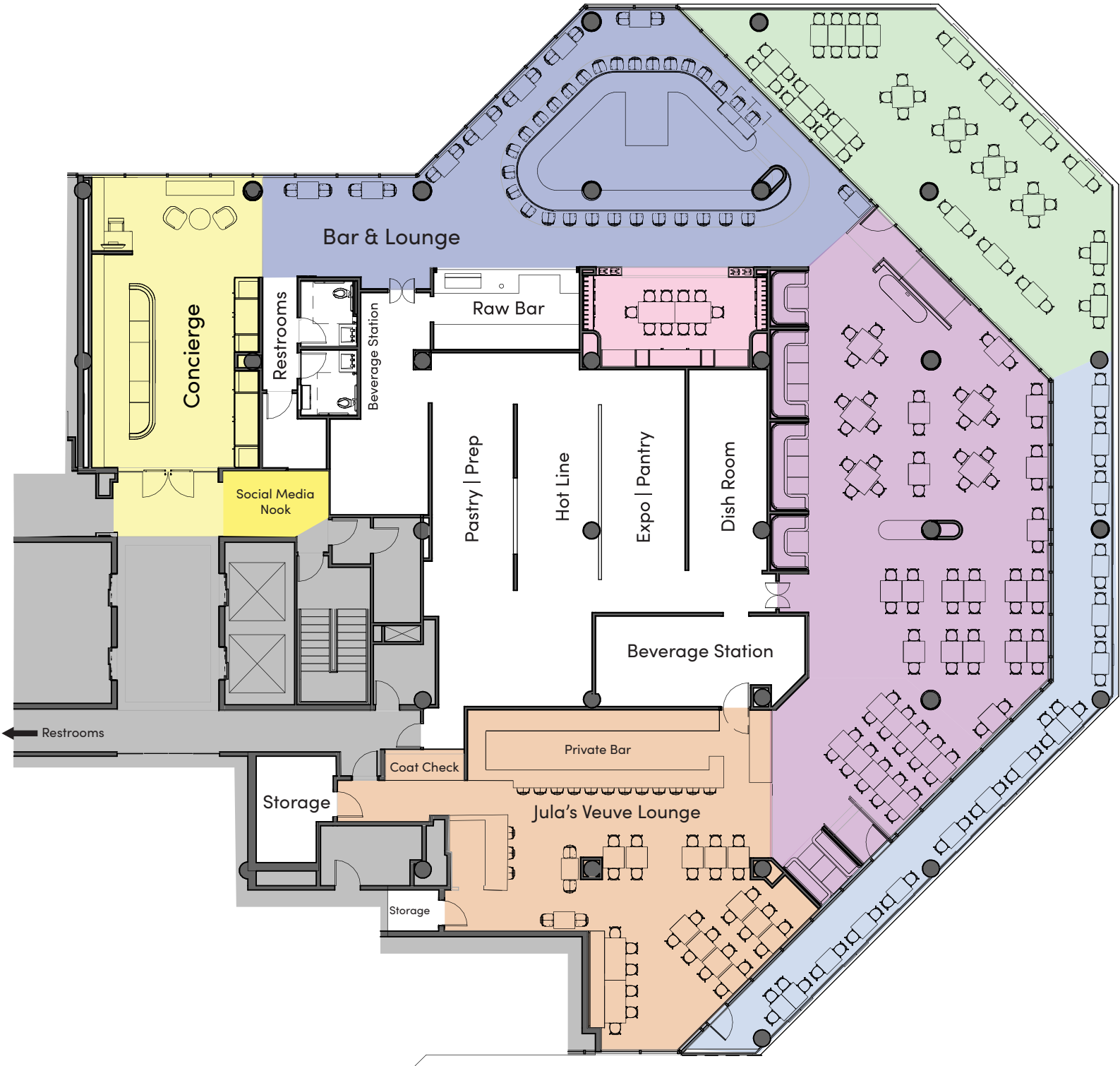

Jula's Veuve Lounge

Capacity: 34 Seated | 50 Standing

2 Hours | \$3,000 F&B  
3 Hours | \$4,500 F&B  
4 Hours | \$6,000 F&B

Dining Room

Capacity: 94 Seated

Lunch | 12-3pm | \$4,500  
Dinner | 5-10pm | \$12,000  
Brunch | 11am-3pm | \$10,000

Waterfront Balcony

Capacity: 32 Seated

Tables W1-W4 | \$1,000 Fee  
Tables W1-W8 | \$1,500 Fee  
Full Balcony | \$2,500 Fee

The Terrace

Capacity: 100 Standing

5-7pm | \$3,500 F&B  
8-10pm | \$3,500 F&B  
6-10pm | \$7,000 F&B

Wine Room

Capacity: 10 Seated

Lunch 12-3pm | \$500 F&B  
Dinner 5-10pm | \$1,000 F&B  
Brunch 12-3pm | \$750 F&B